

## APPLICATION FOR ALL TRIADE VERSIONS

### VERTICAL ADJUSTMENTS

RELEASE THE FIXING SCREWS

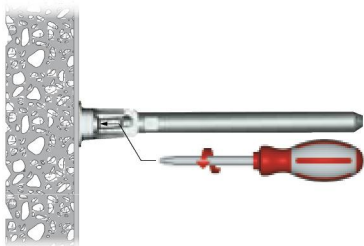

ALIGN BRACKETS VERTICALLY ACCORDINGLY

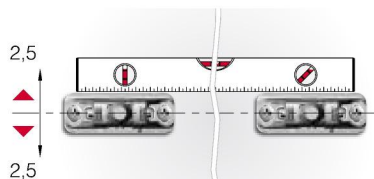

TIGHT THE FIXING SCREWS

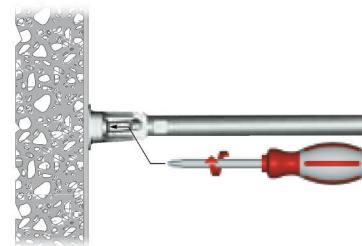

### SHELF INSERTING AND LATERAL ADJUSTMENT

TILT THE SHELF TO MATCH BOTH SUPPORTING PINS AND SHELF HOUSINGS

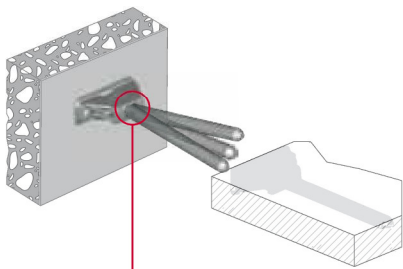

INSERT PARTIALLY THE SHELF

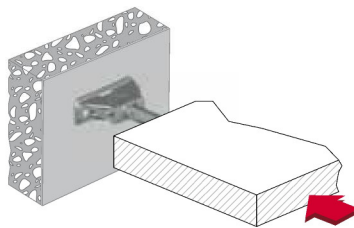

ADJUST THE SHELF Laterally ACCORDING TO THE APPLICATION (i.e. MULTI-SHELF COMPOSITION)

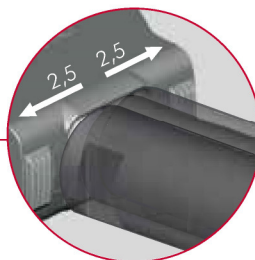
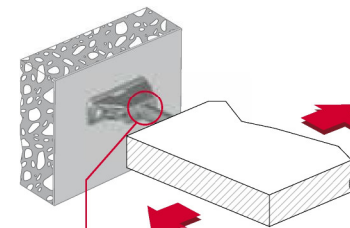

### INCLINATION ADJUSTMENTS

TURN CLOCKWISE THE SUPPORTING PIN WITH A 10 - 12 mm OPEN-ENDED WRENCH TO ADJUST THE SHELF ANGLE FRONT TO BACK ACCORDINGLY

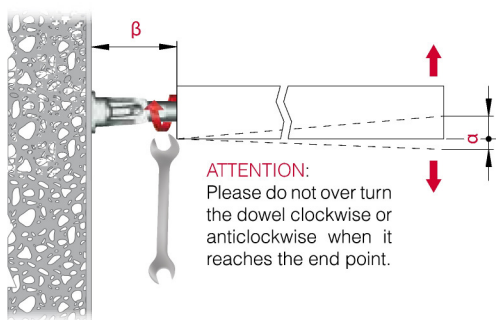

MODEL	$\beta$ (mm)	$\alpha$ (mm)
TRIADE MINI	approx. 45	$\frac{-6}{+13}$
TRIADE	approx. 45	$\frac{-6}{+13}$
TRIADE MAXI	approx. 70	$\frac{-8}{+20}$
TRIADE XXL	approx. 70	$\frac{-8}{+20}$

SCREW THE LOCKING BOLT TO BLOCK THE PIN

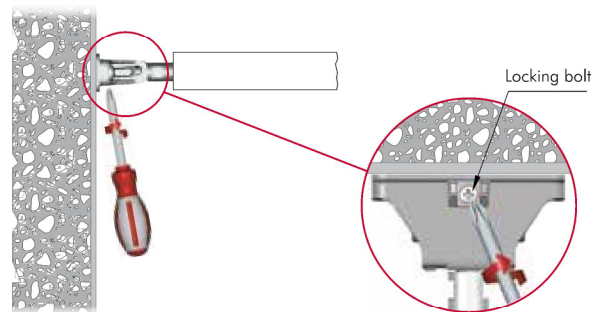

### SHELF INSERTING FOR ALL TRIADE MODELS

PUSH THE SHELF AGAINST THE WALL UNTIL THE END

